

FUTEK MODEL LSM250 (L2331)

PARALLELOGRAM LOAD CELL WITH OVERLOAD PROTECTION (OEM TYPE)

Drawing Number: F11039

INCH [mm] R.O.= Rated Output

WIRING CODE (WC2)

+Excitation	-Excitation	+Signal	-Signal
GREEN	BLACK	WHITE	RED

COLOR CODE FOR THIS SENSOR IS NOT FUTEK STANDARD

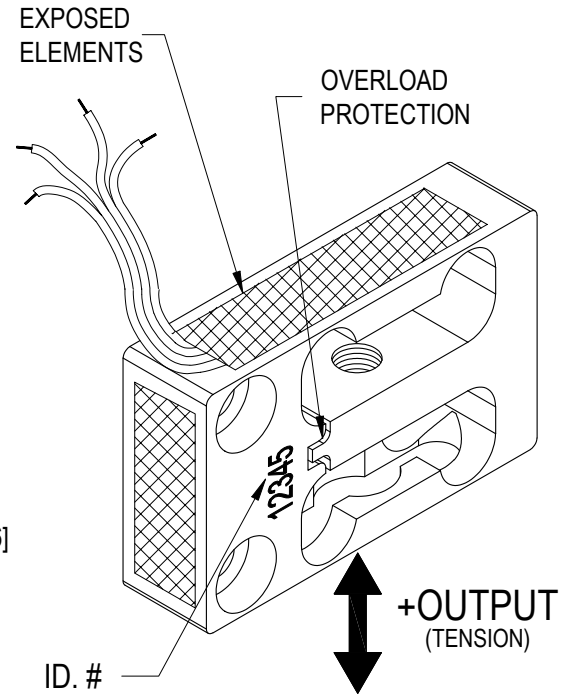
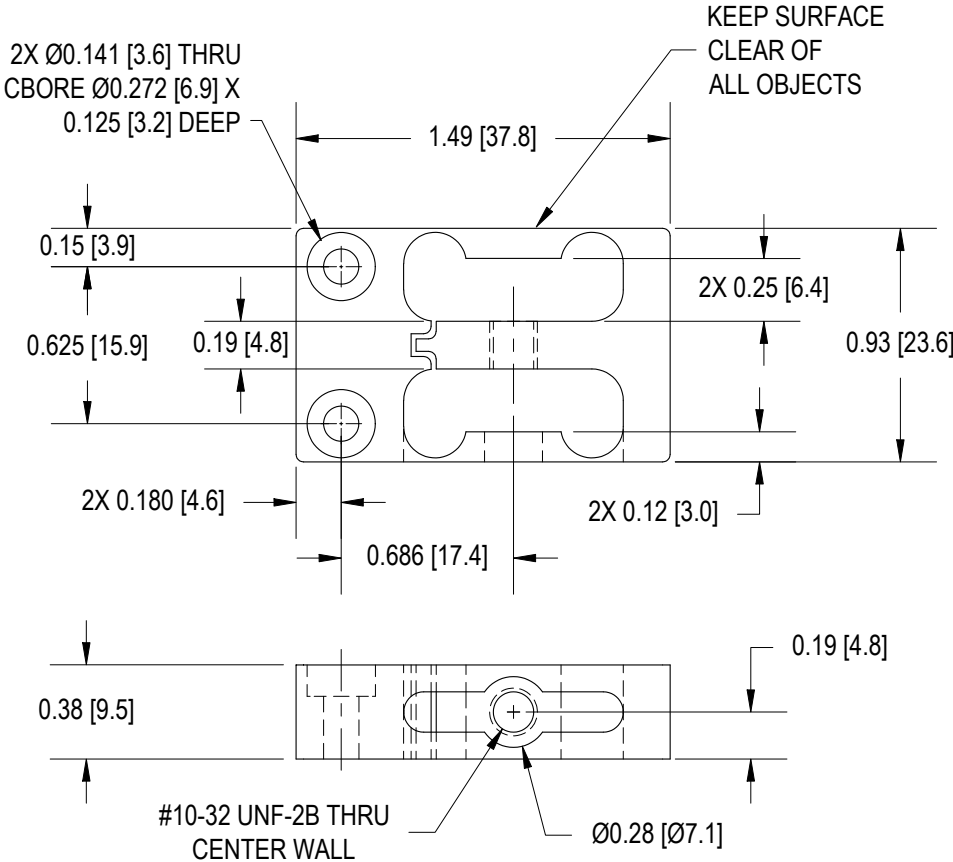

NOTE:

**** HANDLE WITH CARE, ALWAYS MONITOR OUTPUT DURING INSTALLATION. ****

SPECIFICATIONS:

RATED OUTPUT	2 mV/V nom.
SAFE OVERLOAD	50 lb
ZERO BALANCE	±3% of R.O.
EXCITATION (VDC OR VAC)	18 MAX
BRIDGE RESISTANCE	1000 Ω nom.
NONLINEARITY	±0.05% of R.O. IMPROVED ACCURACY
HYSTERESIS	±0.05% of R.O. AVAILABLE CONTACT
NONREPEATABILITY	±0.05% of R.O. FACTORY
CREEP	±0.05% of LOAD.
TEMP. SHIFT ZERO	±0.005% of R.O./°F [0.01% of R.O./°C]
TEMP. SHIFT SPAN	±0.005% of LOAD/°F [0.01% of LOAD/°C]
COMPENSATED TEMP.	60 to 160 °F [15 to 72 °C]
OPERATING TEMP.	-60 to 200 °F [-50 to 93 °C]
WEIGHT	1 oz [28 g]
MATERIAL	ALUMINUM
NOM. DEFLECTION	0.004 [0.10]
CABLE: #29 AWG, 4 Conductor, Spiral Teflon Cable 6 [0.3 m] Long	
ACCESSORIES AND RELATED INSTRUMENTS AVAILABLE	
CALIBRATION (STD)	2 pt. TENSION; 150KΩ SHUNT CAL. VALUE
CALIBRATION (AVAILABLE)	2 pt. COMPRESSION
CALIBRATION TEST EXCITATION	10 VDC

Stock #	CAPACITY	
	lb	N
FSH00011	1/4	1.1
FSH00012	1/2	2.2
FSH00013	1	4.5

FOR HIGHER CAPACITIES REFER TO MODEL LSM300 (L2330)