

FUTEK MODEL TFF500
ITEM# SEE CHART

THRU HOLE REACTION TORQUE SENSOR w/ TEDS

Drawing Number: FI1265-A

INCH [mm] | R.O.= Rated Output

VDC CONNECTOR CODE (Cable Pkg Wiring Code)

TEDS DATA	GND (TEDS)	GND (POWER)	RTN (10 VDC)
5 (Orange)	9 (Blue)	7 (Black)	6 (White)

SIGNAL (10 VDC)	POWER (12-24 VDC)
1 (Green)	2 (Red)

mV/V CONNECTOR CODE (Cable Pkg Wiring Code)

TEDS DATA	GND (TEDS)	-Excitation	-Signal
5 (Orange)	9 (Blue)	7 (Black)	6 (White)

+Signal	+Excitation
1 (Green)	2 (Red)

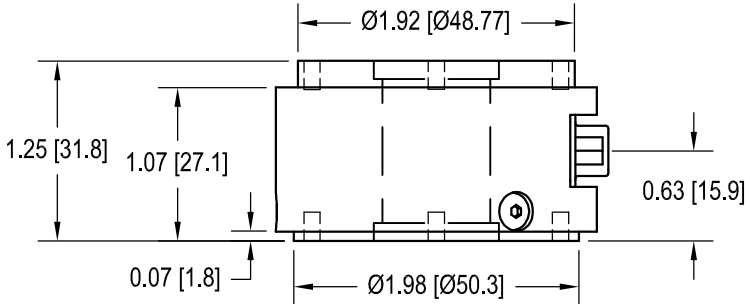
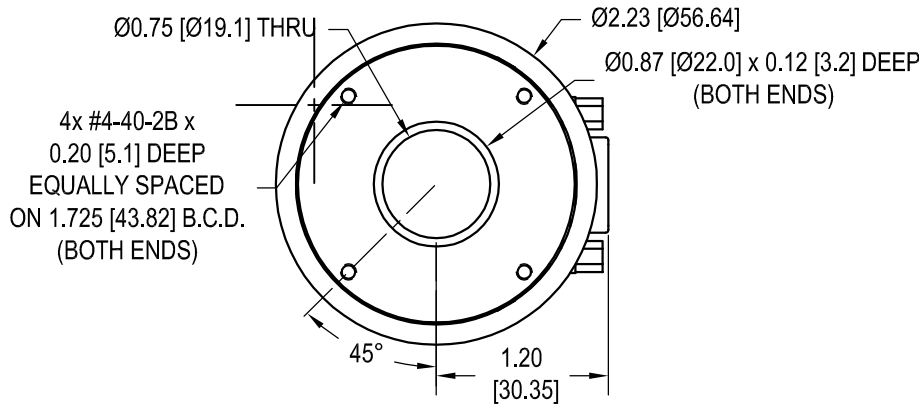
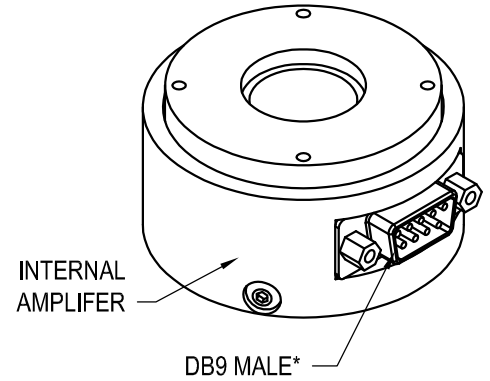

SPECIFICATIONS:

- RATED OUTPUT See Chart
- CAPACITY 100 in-lb
- SAFE OVERLOAD 150% of R.O.
- ZERO BALANCE ±1% of R.O.
- EXCITATION See Chart
- NONLINEARITY ±0.5% of R.O.
- HYSTERESIS ±0.5% of R.O.
- NONREPEATABILITY ±0.1% of R.O.
- TEMP. SHIFT ZERO ±0.02% of R.O./°F (0.04% of R.O./°C)
- TEMP. SHIFT SPAN ±0.02% of LOAD/°F (0.04% of LOAD/°C)
- COMPENSATED TEMP. 60 to 160°F [15 to 71 °C]
- OPERATING TEMP. 0 to 160°F [-17 to 71 °C]
- WEIGHT Approx 0.35 lb
- MATERIAL(COVER) Aluminum, Red Anodize After S/N:12345
- CONNECTOR: DB9 MALE
- ACCESSORIES AND RELATED INSTRUMENTS AVAILABLE
- CALIBRATION (STD) 5 pt. CW; (CCW optional)
- CALIBRATION TEST EXCITATION 10VDC (15 VDC Amplified version)
- Red Anodized Covers After S/N:12345

ITEM#	OUTPUT (nom)	EXCITATION (VDC)
FSH02650	±10 VDC	12-24
FSH03327	±1 mV/V	1-18



This drawing is submitted solely for the information and exclusive use of the original addressee. It is not to be divulged in whole or in part, by any firm or individual without written permission from FUTEK
CAGE CODE # 1X8M6

10 THOMAS
IRVINE, CA 92618 USA
1-800-23-FUTEK (38835)

INTERNET:
<http://www.futek.com>